

**CALIFORNIA DEPARTMENT OF FISH AND GAME
STREAM SURVEY**

FILE FORM No _____

NAME Bear Wallow Creek COUNTY Mendocino

STREAM SECTION Partial FROM Mt. View Rd. TO Mouth LENGTH 1.5 mi.

TRIBUTARY TO Rancheria Creek TWP 13N R 14W SEC 8

OTHER NAMES Not known RIVER SYSTEM Navarro River

SOURCES OF DATA Personal observation and Bob Keller, seasonal aid

- EXTENT OF OBSERVATION
- Include Name of Surveyor, Date, Etc.
- LOCATION
- RELATION TO OTHER WATERS
- GENERAL DESCRIPTION
- Watershed
- Immediate Drainage Basin
- Altitude (Range)
- Gradient
- Width
- Depth
- Flow (Range)
- Velocity
- Bottom
- Spawning Areas
- Pools
- Shelter
- Barriers
- Diversions
- Temperatures
- Food
- Aquatic Plants
- Water Conditions
- Pollution
- Springs
- FISHES PRESENT AND SUCCESS
- OTHER VERTEBRATES
- FISHING INTENSITY
- OTHER RECREATIONAL USE
- ACCESSIBILITY
- OWNERSHIP
- POSTED OR OPEN
- IMPROVEMENTS
- PAST STOCKING
- GENERAL ESTIMATE
- RECOMMENDED MANAGEMENT
- SKETCH MAP
- REFERENCES AND MAPS

EXTENT OF OBSERVATION - This tributary was checked on foot and by car from Mt. View Road downstream to mouth on Sept. 26, 1962 by Bob Keller and Richard Moore, seasonal aids. All major tributaries of the Navarro River system were also surveyed by Department personnel this season and are listed in separate reports.

LOCATION - Bear Wallow Creek heads 2 air miles west of Boonville and flows 1.5 miles southwest to enter Rancheria Creek.

RELATION TO OTHER WATERS - Bear Wallow Creek is considered at present to be a poor to fair rainbow trout and/or steelhead spawning and nursery stream. This stream is potentially a good spawning and nursery stream but suffers from recent logging pollution. Bear Wallow Creek is a tributary of the lower Rancheria Creek and is below average in both the size of the drainage and the potential fisheries value.

GENERAL DESCRIPTION - Watershed & Immediate Drainage Basin - Bear Wallow Creek heads in a rather steep V-shaped canyon of secondary redwood-Douglas fir with a light brown powdery shallow soil over bedrock. The entire stream has been logged within the last ten years. This stream was logged from the confluence of Honey Creek and Bear Wallow Creek upstream into Bear Wallow Creek during the 1962 season. There was no cultivation in this stream bed. Vegetation in the bottom of the canyon is mainly redwood and fir association. The north facing slopes have extensive areas of deciduous trees. South facing slopes are mainly scattered brush and grass. Shade and shelter are good except in most recently logged areas.

Altitude - Upstream areas at Mt. View Road bridge 1020 ft; mouth 520 ft.

Gradient - Overall average 6.5 ft./100 ft. Much steeper in headwaters, slightly less in mid and lower sections.

Width - Riffles average 1 ft., ranged from 1/2 to 10 ft. Pools averaged 4 ft. ranged from 1 to 10 feet. Streambed averaged 20 ft, ranged from 10 to 15 ft.

Depth - Riffles averaged 1 inch; ranged 1/2 inch to 3 inches. Pools averaged 4 inches, ranged from 1 inch to 12 inches. Stream bed averaged 4 ft. ranged from 3 ft. to 10 ft.

Flow - At mouth, summer minimum estimated at 1/2 cfs. Winter maximum estimated to exceed 14 inches in depth. Flow on date of survey estimated by float method to 0.5 cfs, decreasing upstream to intermittent at Mt. View Road.

Velocity - Sluggish to rapid. Sluggish due to recent logging. Rapid due to gradient in upper section.

Bottom - Estimated at 90% overburden composed of 70% silt, 5% gravel, 15% sand and 5% organic debris. The remaining 10% was bedrock and gravel, rubble and boulder.

BEAR WALLOW CREEK P-2
Mendocino County

Spawning Areas - Judged poor to poorer. Poor quality of stream beds are due to recent logging, slash, jams as a result of logging, road building and driving down stream bed. Percentage of stream bed available as spawning less than 1%.

Pools - Poor throughout due to excessive silt. The frequency of pools are 30% pools to 70% riffles.

Shelter - Poor due to extensive overburden and silt plus scarcity of stream side vegetation.

Barriers - The first upstream barrier is a 6-foot bedrock barrier immediately downstream from Mt. View Road bridge.

Diversions - No diversions noted.

Temperatures - At Honey Creek on September 26, at 0900 - water 56° F; air 54° F. At mouth at 1100 hour - water 57°F; air 66°F, Weather on this date was clear and sunny.

Weather two weeks previous - clear and sunny. High water temperatures should stabilize between 55° and 60°F,

Food - Snails abundant. Caddis fly scarce. Snails 3+ per foot, caddis fly 1 per sq. ft. mayfly 3 per sq. ft. water pennies 1 per sq. foot.

Aquatic Plants - Filamentous submergent green algae abundant. Tules present upstream from Mt. View Road bridge. Aquatic plants considered rare to common.

Winter Conditions - Appear moderate. Maximum flow at mouth during freshets 14-18 in. Depth indicated by recent high water marks and debris on the bank.

Pollution - Entire section surveyed suffers from extensive logging pollution. Logging pollution involves building roads in stream bed, disposing of slash in stream bed, building landings in stream bed and leaving sluggish pools of water in areas of low gradient.

Springs - Rare. This is expected following long dry summer season,

FISHES PRESENT AND SUCCESS - Fishes present are RT/SH. They average approximately 2-3/4 inches and ranged from 2-4 inches in length. Average abundance were 6-8 fish per pool; overall average of stream bed estimated at 20 fish per 100 ft, of stream bed. Success of RT-SH in this stream estimated poor to fair with no fish noted from Honey Creek upstream. Fish noted did appear active; however, natural propagation is estimated at only poor to fair. The overall poor condition of fishes in the stream believed due to recent logging. The surveyor feels conditions will get much worse following 1962-63 wet season due to this recent logging.

OTHER VERTEBRATES - Newt and deer were noted.

FISHING INTENSITY - Not known, believed little. Lack of fishing interest due to scarcity and small size of fishes present.

OTHER RECREATIONAL USE - Deer hunting.

ACCESSIBILITY - Bear Wallow Creek accessible throughout its length from Mt. View Road which parallels the stream approximately 6-8 miles and 30 minutes from Boonville.

Travel time from San Francisco - 3 hours.

OWNERSHIP - See accompanying Bear Wallow Creek survey.

POSTED OR OPEN - Entire stream appears to be open.

IMPROVEMENTS - Entire stream from Mt. View Road bridge downstream needs stream clearance. Slides due to recent logging roads having been built may also need to be removed following winter season.

PAST STOCKING - Not known.

GENERAL ESTIMATE - Bear Wallow Creek is of minor importance as a SH/RT spawning and nursery stream in its present condition. Indications are it will get worse following 1962-63 winter season. Bear Wallow Creek was a fair to good steelhead rainbow trout spawning and nursery stream prior to logging damage. If present conditions are allowed to continue, surveyor feels present regulations and/or enforcement is not adequate.

RECOMMENDED MANAGEMENT:

1. Recommend management as a steelhead and/or rainbow trout spawning and nursery stream.
2. Recommend stream clearance on the stream.
3. Recommend occasional check for future logging damage.
4. Recommend future downstream water release for water application to be 1/3 cfs or entire flow of stream, whichever is less.

SKETCH MAP - See attached.

REFERENCES & MAPS - USGS topographic map 7 1/2 minute advanced sheet 1960 (Ornbaun) northwest and southwest Boonville.

Richard Moore/cd 11-30-62

Bear Wallow Creek
T 13N R 14W Sec 5

1.	10' bedrock Falls (NoWood)	25.	35' SILTED IN
2.	30'	26.	30'
3.	10' silted in	27.	40'
4.	30' " "	28.	50'
5.	20' " "	29.	60'
6.	60' W 14' D3, V 75% silted in	30.	80'
7.	30' silted in	31.	90'
8.	10' " "	32.	115' log landing (Honey cr)
9.	10' " "	33.	200' log landing
10.	40' " "	34.	20'
11.	30'	35.	10'
12.	40'	36.	10'
13.	40'	37.	30' silted in (partial barrier)
14.	30'	38.	30'
15.	5'	39.	200'
16.	60' New Logging Begins Below Horn	40.	60'
17.	40' silted in	41.	100'
18.	30' " "	42.	100'
19.	60' " "	43.	100'
20.	40' " "	44.	10'
21.	45' " "	45.	10'
22.	30' " "	46.	10'
23.	10'	47.	100'
24.	70'	48.	20'

Bear Wallow Creek
T 13N R 14W sec 5

49. 30'

50. 65'

51. 95'

52. 70'

53. 10' Potential Jam'

54. 200'

55.

Bear Wallow Creek

T 13N R 14W Sec. 5

Spawning and Nursery Area in miles

1. Now satisfactory for SH & SS 0.0
2. To be improved 2.0
3. Available after improvement 2.0

Surveyor TPL Moore

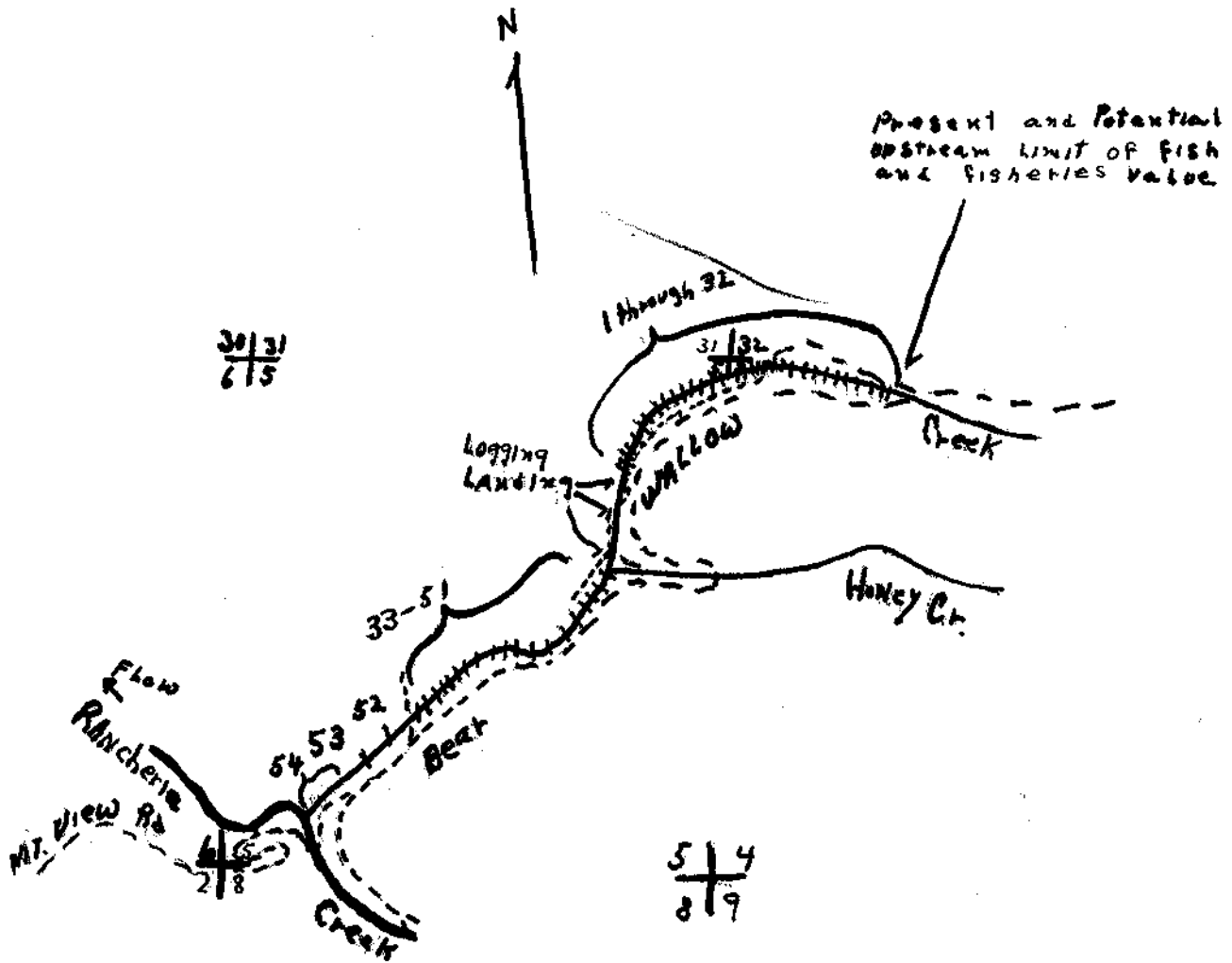

1/4 mi

Add 15% for debris Not listed between numbered dams